

— SAN MATEO COUNTY —
CALIFORNIA VOTER'S CHOICE ACT

**ADDITIONS TO THE APPENDIX TO
THE SUPPLEMENT
TO JANUARY 2020 TO JANUARY 2024
ELECTION ADMINISTRATION PLAN
FOR THE SEPTEMBER 14, 2021
CALIFORNIA GUBERNATORIAL
RECALL ELECTION**



OFFICE OF MARK CHURCH
CHIEF ELECTIONS OFFICER & ASSESSOR-COUNTY CLERK-RECORDER

REGISTRATION & ELECTIONS DIVISION

40 Tower Road, San Mateo, CA 94402

phone 650.312.5222 **fax** 650.312.5348

email registrar@smcacre.org **web** www.smcvote.org

  @smcvote

This page intentionally left blank

Vote Center and Drop Box locations

Vote Center Locations

30-Day Vote Centers: Weekdays, August 16 - September 14; Weekends, September 4 - 5, 11 - 12

Redwood City	Assessor-County Clerk-Recorder	555 County Center
San Mateo	Registration & Elections Division	40 Tower Road
South San Francisco	Main Library	840 West Orange Avenue

11-Day Vote Centers: September 4 - September 14

Burlingame	City Hall, Council Chambers	501 Primrose Road
Daly City	Pacelli Event Center, Gymnasium	145 Lake Merced Boulevard
East Palo Alto	Lewis and Joan Platt East Palo Alto Family YMCA	550 Bell Street
Half Moon Bay	Emergency Operations Center	537 Kelly Avenue
San Carlos	Library, Community Room, 2 nd floor	610 Elm Street

4-Day Vote Centers: September 11 - September 14

Atherton	Menlo College, El Camino Hall	1000 El Camino Real
Belmont	Twin Pines Lodge	40 Twin Pines Lane
Brisbane	City Hall, Council Chambers	50 Park Place
Colma	Community Center, Banquet Hall	1520 Hillside Boulevard
Foster City	William E. Walker Recreation Center, Art Gallery	650 Shell Boulevard
Hillsborough	Town Hall	1600 Floribunda Avenue
Menlo Park	Arrillaga Family Recreation Center, Sequoia Room	700 Alma Street
Millbrae	Community Center	623 Magnolia Avenue
Pacifica	St. Peter Parish	700 Oddstad Boulevard
Portola Valley	Town Center, Community Hall	765 Portola Road
San Bruno	Belle Air Elementary School	567 El Camino Real
Woodside	Woodside Village Church	3154 Woodside Road

2-Day Pop-up Vote Centers: September 13 - September 14

La Honda	Fire Brigade	8945 La Honda Road
Pescadero	La Honda-Pescadero Unified School District	360 Butano Cutoff

Drop Box Locations Availability of indoor Ballot Drop Boxes is subject to the facility's operating hours

Atherton	Town Hall (inside)	80 Fair Oaks Lane
Belmont	City Hall (outside)	1 Twin Pines Lane
Belmont	Library (outside)	1110 Alameda de las Pulgas
Brisbane	City Hall (outside)	50 Park Place
Brisbane	Library (inside)	163 Visitacion Avenue
Burlingame	City Hall (outside)	501 Primrose Road
Burlingame	Temporary Recreation Center (outside)	1010 Burlingame Avenue
Colma	Community Center (inside)	1520 Hillside Boulevard
Colma	Town Hall (outside)	1198 El Camino Real
Daly City	City Hall (outside)	333 90th Street
Daly City	City Hall Parking Lot (drive-up)	Edgeworth Avenue at 91st
East Palo Alto	Government Center (outside)	2415 University Avenue
East Palo Alto	Ravenswood City School District (inside)	2120 Euclid Avenue
East Palo Alto	University Circle (inside)	1900 University Avenue
Foster City	City Hall (drive-up)	610 Foster City Boulevard
Half Moon Bay	City Hall (outside)	501 Main Street
Half Moon Bay	Library (inside)	620 Correas Street
Half Moon Bay	New Leaf Community Market (inside)	150 San Mateo Road
Hillsborough	Town Hall (drive-up)	1600 Floribunda Avenue
La Honda	Fire Brigade (outside)	8945 La Honda Road
Menlo Park	Boys & Girls Club (outside)	401 Pierce Road
Menlo Park	City Hall (outside)	701 Laurel Street
Millbrae	City Hall (outside)	621 Magnolia Avenue
Pacifica	City Hall (drive-up)	170 Santa Maria Avenue
Pacifica	Community Center (outside)	540 Crespi Drive
Pescadero	Fire Station 59 (drive-up)	1200 Pescadero Creek Road
Portola Valley	Town Center (outside)	765 Portola Road
Redwood City	Assessor-County Clerk-Recorder (inside)	555 County Center
Redwood City	City Hall (outside)	1017 Middlefield Road
Redwood City	Community Activities Building (drive-up)	1400 Roosevelt Avenue
Redwood City	555 County Center (outside)	Middlefield Road at Bradford
Redwood City	North Fair Oaks Library (inside)	2510 Middlefield Road
San Bruno	City Hall (outside)	570 Linden Avenue
San Bruno	Senior Center (outside - side of building)	1555 Crystal Springs Road
San Carlos	City Hall Dog Park (outside)	1401 San Carlos Avenue
San Carlos	Library (inside)	610 Elm Street
San Mateo	City Hall (outside)	330 West 20th Avenue
San Mateo	Dr. Martin Luther King Jr., Community Ctr (drive-up)	725 Monte Diablo Avenue
San Mateo	Marina Branch Library (outside)	1530 Susan Court
San Mateo	Registration & Elections Division (inside and drive-up)	40 Tower Road
South San Francisco	City Hall (inside)	400 Grand Avenue
South San Francisco	City Hall Back Parking Lot (drive-up)	400 Grand Avenue
South San Francisco	Main Library Parking Lot (drive-up)	840 West Orange Avenue
Woodside	Library (inside)	3140 Woodside Road
Woodside	Town Hall (outside)	2955 Woodside Road

List as of July 30, 2021 – subject to change

Vote Center Layout – Small Room Example

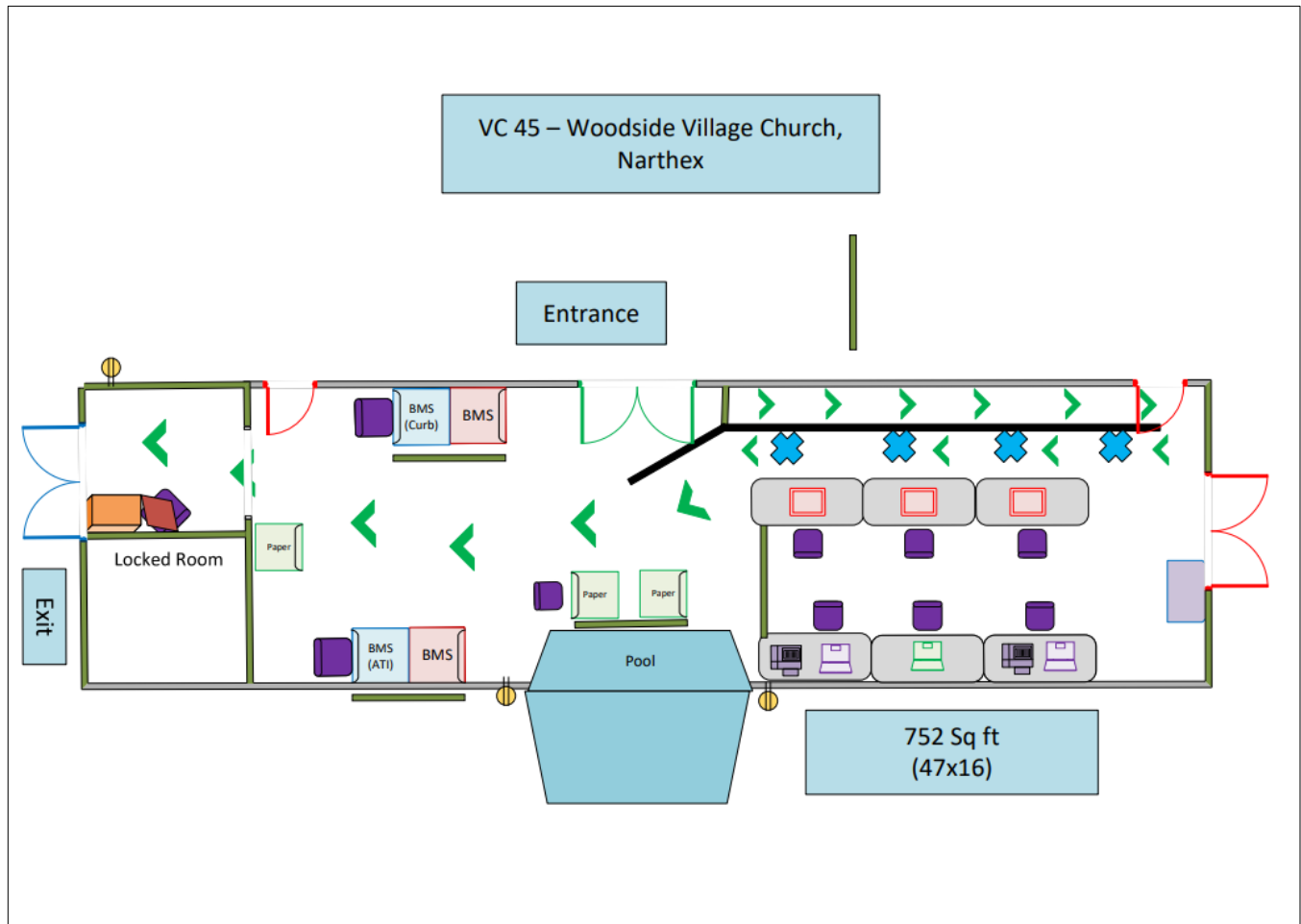

Vote Center Layout – Medium Room Example

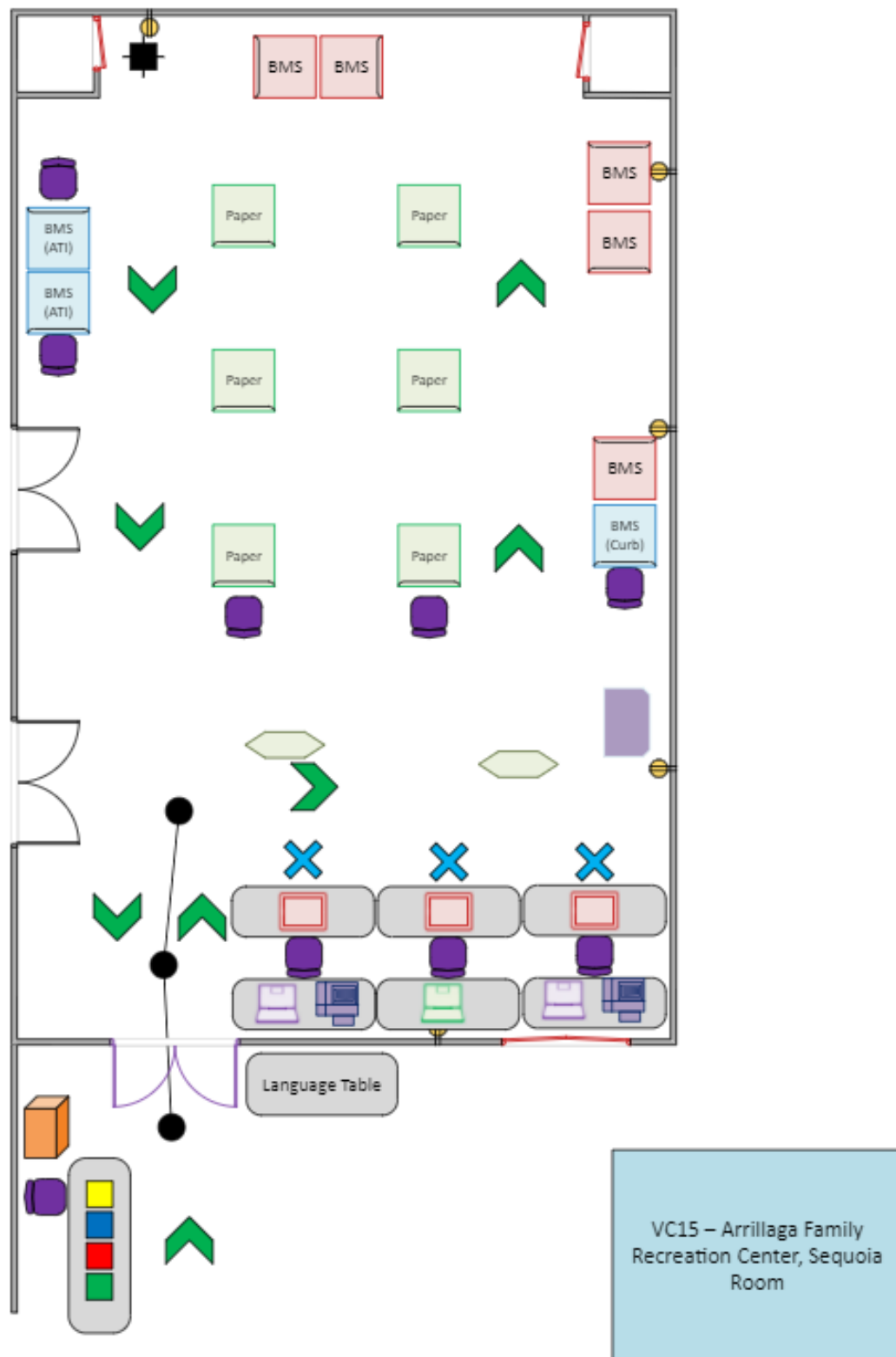

Vote Center Layout – Large Room Example

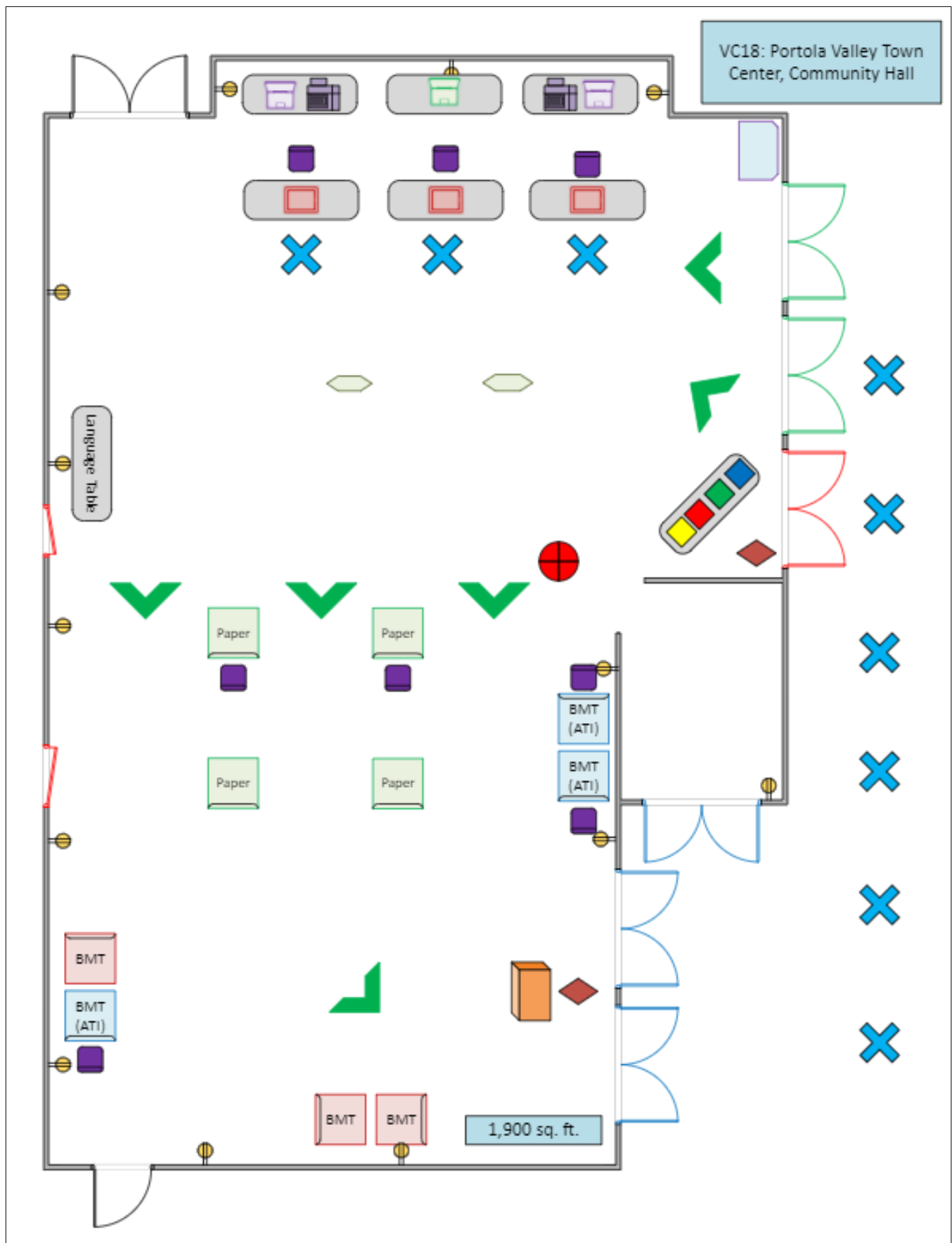

Community Partner Additions

Supervisory District 5

	Phone	E-mail Address
Innovate Public Schools	650.562.6200	mmoten@innovateschools.org

Throughout County/Out of County

Catholic Charities	415.972.1200	jfergusonflout@catholiccharitiessf.org
San Mateo County Latinx Democratic Club		raymondlaños@gmail.com
San Mateo County Office of Education	650.802.5553	nclay@smcoe.org

Community Events

2021 Calendar Additions*

August 3	National Night Out
August 5	Central Park Concert, San Mateo
August	Movies on the Square, Redwood City
August 21	Rotary Club of San Mateo First Annual Classic Car Show
August 27 - 28	Pub in the Park, Redwood City
August	Dignity on Wheels

**Events are subject to change.*

Media Partners Additions

Newspapers

India Currents
San Francisco Chronicle

Radio

Bolly 92.3

Online

Belle Haven News
Radio Zindagi
Spotify

Direct Voter Contact sent mid-July 2021

Postcard 1



OFFICE OF MARK CHURCH
CHIEF ELECTIONS OFFICER & ASSESSOR-COUNTY CLERK-RECORDER
REGISTRATION & ELECTIONS DIVISION

September 14, 2021 California Gubernatorial Recall Election

MORE DAYS, MORE WAYS TO VOTE!

On August 16, 2021, the Official Ballot for the September 14, 2021 California Gubernatorial Recall Election will be mailed to every registered voter in San Mateo County. Included with the Official Ballot will be the Sample Ballot and Official Voter Information Pamphlet which will provide important election information on available voting options and services. Voters may vote by mail, vote in person at one of our 20 Vote Center Locations, drop off their ballot at one of our 41 Ballot Drop Box Locations or use our Remote Accessible Vote by Mail Ballot System.

Ways to Vote:

 **Vote by Mail**

 **Drop Off**

 **Vote in Person**

 **Remote Accessible
Vote by Mail Ballot System**

3 Vote Centers open weekdays from August 16 to September 3



8 Vote Centers open daily from September 4 to September 10*

20 Vote Centers open daily from September 11 to September 14

2 Pop-Up Vote Centers open September 13 and September 14

**Vote Centers will be open on Labor Day, Monday, September 6, 2021.*

For more information on voting services available for the California Gubernatorial Recall Election, please visit www.smcvote.org or call or text 650.312.5222.

Visit www.smcvote.org or our   @smcvote
Call or Text: 650.312.5222

Postcards sent in English, Spanish and Chinese based on voter's language preference selected on their voter registration form.

Postcard 2



CHIEF ELECTIONS OFFICER & ASSESSOR-COUNTY CLERK-RECORDER

REGISTRATION & ELECTIONS DIVISION

MORE DAYS, MORE WAYS TO VOTE!

On September 24, 2020, the Sample Ballot and Voter Information Pamphlet will be mailed to every registered voter in San Mateo County and available online: www.smcvote.org. The pamphlet provides important information on the **November 3, 2020** Presidential General Election and the different voting options available.

“Where’s my ballot?” is a new feature enabling voters to track their ballots from the moment they are mailed by our office to the time they are returned. Sign up at www.smcvote.org to receive text alerts, email notifications and updates.



Voting by Mail is Safe, Easy and Convenient. All registered voters will be mailed an **Official Ballot**, with a postage-paid return envelope, starting **October 5, 2020**. Return your ballot in the mail, to a Ballot Drop Box or at a Vote Center.



Ballot Drop-Box Locations. There will be 36 Ballot Drop Box locations strategically placed throughout the County. View locations at www.smcvote.org.



Vote Centers. There will be 45 Vote Centers located throughout the county for in-person voting and voter services. For Vote Center locations and hours, visit www.smcvote.org.





Curbside Ballot Drop-Off will be available at all 45 Vote Centers on Election Day, allowing voters to safely deliver their ballots at Vote Centers without leaving their vehicles.



COVID-19. All Vote Centers comply with County Health Department and CDC COVID-19 safety standards. Voters must wear masks and adhere to all social distancing practices.

Vote Centers will be closed on Columbus Day, Monday, October 12, 2020.

Visit www.smcvote.org or   @smcvote
Call or Text: 650.312.5222

Call or Text: 650.312.5222